



SUDIO

Vogue



Manual

Bluetooth Handsfree Speakerphone

To get the most out of your Sudio Vogue, make sure you read this owner's guide. The Sudio Vogue is designed for use with a Bluetooth enabled mobile phone, PDA or computer.

Product Care:

- Do not attempt to disassemble this product or modify it in any way.
- Take care to keep this product away from liquids and direct sunlight/extreme heat and cool conditions between -20°C and +60°C.
- Do not leave the Sudio Vogue connected to the charger for extended periods of time as excessive charging will reduce battery life.

Note: This product is intended to be charged only with the USB vehicle charger/cable provided in box.



Disclaimer:

Without written permission from the original manufacturer, reproduction, transfer, distribution or storage of part or all of the contents in this document in any form is prohibited. The company reserves the right to make any changes and improvements to the product described in this document without prior notice. This device can only be used if your mobile phone supports Bluetooth profiles and your network operator supports the functions as described in this manual.

Important Safety Instructions:

- Only use the USB vehicle charger provided in the box.
- Check the laws and regulations on the use of mobile phones and handsfree equipment in the areas where you drive.
- Do not allow children to play with your Sudio Vogue since it contains small parts that could become a choking hazard.
- Keep this product away from liquids and direct sunlight/extreme heat/cool conditions between -20°C and +60°C.
- This device contains a lithium polymer battery. Keep it away from fire at all times (including if you discard the device) or the battery may explode.

- The Sudio Vogue and its rechargeable battery must be properly disposed of or, can be recycled. Please contact your local recycling centre for guidelines on how to dispose of the used product.
- Ensure the Sudio Vogue volume level is set to low the first time you use the Sudio Vogue. The level of the volume can vary and could cause permanent hearing loss if it is not adjusted carefully.

Certification and Safety Approvals:

This product has been tested and found to comply with Bluetooth BQB requirements, part 15 of FCC rules, R&TTE Directive 99/5/EC or CE marked requirements.

Warning: Users should not make changes or modify the device in any way. Changes or modifications without approval by the party responsible for compliance could void the user's authority to operate the device.

This device complies with part 15 of the FCC Rules. Operation is subject to the following two conditions:

- (1) This device may not cause harmful interference, and (2) this device must accept any interference received, including interference that may cause undesired operation.

This equipment has been tested and found to comply with the limits for a Class B digital device, pursuant to part 15 of the FCC Rules. These limits are designed to provide reasonable protection against harmful interference in a residential installation.

This equipment emits radio frequency energy and, if not installed and used in accordance with the instructions, may cause harmful interference to radio communications. However, there is no guarantee that interference will not occur in a particular installation. If this equipment does cause harmful interference to radio or television reception, which can be determined by turning the equipment off and on, the user is encouraged to try to correct the interference by one or more of the following measures:

- Reorient or relocate the receiving antenna.
- Increase the separation between the equipment and receiver.



Caution:

Any changes or modifications not expressly approved by the guarantee of this device could void the user's authority to operate the equipment.

RF exposure warning:

The equipment complies with FCC RF exposure limits set forth for an uncontrolled environment. The equipment must not be co-located or operating in conjunction with any other antenna or transmitter.

Sudio, Sudio Vogue and Vogue are trademarks of Force Technology International Pty Ltd. Sudio is proudly distributed globally by Force Technology International Pty Ltd.



Contents

1	Introduction	6
1.1	What is Bluetooth	6
1.2	How the Sudio Vogue works	7
1.3	Product Features	7
1.4	Product Diagram	8
1.5	Box Contents	8
2	Getting Started	9
2.1	Charging the Sudio Vogue	9
2.2	Turning the Sudio Vogue On/Off	10
2.3	Pairing	10
3	Using the Sudio Vogue	12
3.1	Connecting and Disconnecting the Sudio Vogue	12
3.2	Call Functions	13
4	Maintenance	16
5	Frequently Asked Questions	17
6	Technical Specifications	19





1.0 Introduction

1.1 What is Bluetooth?

Bluetooth technology enables devices to communicate over short distances without being connected by cables or wires. Any two Bluetooth-compatible products, such as a mobile phone, handsfree speakerphone, Personal Digital Assistant (PDA), Personal Computer (PC), headset, mouse, keyboard or printer can communicate with each other wirelessly via a Bluetooth connection. Bluetooth is an internationally standardised technology, meaning that Bluetooth products have universal compatibility. The Sudio Vogue uses Class II Bluetooth technology meaning it can be used within a 10 metre range of the device it is paired to.

Though line-of-sight is not required, Bluetooth connections can sometimes be subject to interference from obstructions such as walls, human bodies, and other electronic devices. In addition, due to product variations Bluetooth devices sourced from different manufacturers can sometimes experience interoperability issues. If this is of concern, check with the appropriate product manufacturers to confirm product compatibility.



1.2 How the Sudio Vogue works

The Sudio Vogue Bluetooth Handsfree Speakerphone uses Bluetooth technology to connect to your mobile phone so you can use it handsfree while you drive. With a full duplex system and Digital Signal Processor (DSP) technology, the Sudio Vogue pairs with your mobile to transmit your calls over an excellent quality speakerphone, making it the perfect solution for when you're driving.

1.3 Product Features

- Small and thin design for unobtrusive visibility when driving.
- Digital Signal Processor (DSP) technology for noise reduction and echo cancellation.
- No installation required.
- Full duplex system for effective two way communication.
- Auto Power Off function to preserve battery life.
- One touch answer, voice dialling, reject incoming calls, last number redial.
- Software upgradeable.
- Re-chargeable lithium polymer battery.
- Up to 10 hours talk time.
- Up to 480 hours stand by time.
- 2 year warranty.
- Replaceable battery.



1.4 Product Diagram

1. Speaker
2. Mute button
3. Volume up
4. Volume down
5. Microphone
6. Multi-function button
7. Blue indicator LED
8. Red indicator LED
9. Charging port

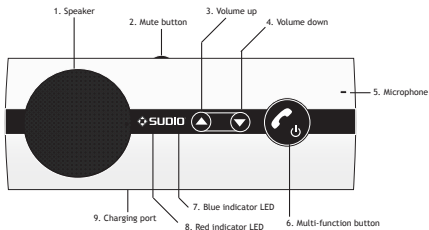

1.5 Box Contents

- Sudio Vogue Bluetooth Handsfree Speakerphone
- USB Vehicle Charger
- USB Charger Cable
- Sun Visor Clip
- Sudio Vogue Manual
- Warranty Card



2.0 Getting Started

2.1 Charging the Sudio Vogue

The Sudio Vogue uses an advanced lithium polymer rechargeable battery. It is important that you charge the Sudio Vogue for 3 hours the first time you use it, to ensure the battery is fully charged ready for use and for best performance. Should the need arise the battery is also replaceable.

Charging the Sudio Vogue in your car:

Using the vehicle charger and USB charger cable provided, connect the Sudio Vogue to the USB charger cable and the USB charger cable to the vehicle charger. Plug the vehicle charger into your car's power outlet. The LED indicator light will stay red on the Sudio Vogue indicating that it is being charged. When the Sudio Vogue is fully charged, the red indicator LED will switch off. When the battery of the Sudio Vogue is low again, the Sudio Vogue will beep intermittently, indicating that it needs to be charged again.

Charging the Sudio Vogue using your computer:

You can also charge the Sudio Vogue using your computer and the USB charger cable. Simply plug the USB charger cable into the USB port on your computer and connect the charging end of the USB charger cable into the Sudio Vogue. The LED indicator light will stay red on the Sudio Vogue until it is fully charged.



2.2 Turning the Sudio Vogue On/Off

To turn the Sudio Vogue on, press and hold the multi-function button for 3 seconds until you hear a short beep. The blue indicator LED will flash on for 3 seconds.

To turn the Sudio Vogue off, press and hold the multi function button for 3 seconds until you hear a long beep. The red indicator LED will flash on for 3 seconds.

2.3 Pairing

2.3.1 What is pairing?

Before you use the Sudio Vogue you must first pair it with your mobile phone. Pairing is the process of establishing an exclusive relationship between two Bluetooth devices.

2.3.2 What is a passkey?

Paired Bluetooth devices share a unique passkey (also referred to as a link key), by which they authenticate with each other when connecting via Bluetooth. The passkey can be alphanumeric, numbers, or letters, and must consist of one to sixteen characters. The passkey ensures that information passed is exclusive between those two devices only. See section 2.3.3 for your passkey information.



2.3.3 Pairing the Sudio Vogue with your mobile phone

Before you can make and receive calls, you must pair the Sudio Vogue with your mobile phone.

Note: you can only pair devices that are Bluetooth enabled. To see if your mobile phone is Bluetooth enabled, check your mobile phone's user guide.

To pair the Sudio Vogue with your mobile phone simply:

1. Ensure the Sudio Vogue is powered off and your mobile phone is powered on with Bluetooth enabled.
2. To place the Sudio Vogue in pairing mode, press the multi-function button for at least 7 seconds until you hear a long beep and see the red and blue indicator LEDs flashing.
This indicates that the Sudio Vogue has entered pairing mode.
3. Use your mobile phone's menu to search for Bluetooth audio devices and select 'Sudio Vogue' from the list of found devices. Your mobile phone will prompt you for a pass key.
4. Enter the **passkey 0000** on your mobile phone. When the Sudio Vogue is successfully paired, you will hear a high pitched tone indicating that it is paired with your mobile phone.

Note: If both devices do not pair within two minutes, the Sudio Vogue will go into standby mode (the blue LED light blinks every 10 seconds) and you will need to initiate re-pairing by repeating steps 1 to 4 above.



3.0 Using the Sudio Vogue

3.1 Connecting/Disconnecting the Sudio Vogue

3.1.1 Connecting the Sudio Vogue to your mobile phone

Connect the Sudio Vogue to your mobile phone by pushing the multi-function button of the Sudio Vogue with one quick press.

3.1.2 Disconnecting the Sudio Vogue from your mobile phone

To disconnect, navigate to your paired Bluetooth devices list on your mobile phone and select the disconnect option.

3.2 Call Functions



3.2.1 Answer a call

To answer a call, push the multi-function button on the Sudio Vogue with one quick press. It may take a few seconds to accept the call.

3.2.2 End a call

To end a call, push the multi-function button on the Sudio Vogue with one quick press.

3.2.3 Voice Dialling*

Before you can use voice dialling with the Sudio Vogue, you must set up voice tags on your mobile phone and, activate the voice dialling function within your mobile phone. Consult your mobile phone's user guide for these instructions.

To place a call using voice dialling, push the multi-function button with one quick press. You will hear a short beep. Next, say the name that you wish to call using the voice tag that you have previously recorded for that number. If you say nothing, the voice dialling function will cancel and you will have to press the multi-function button again to activate voice dialling. Once you've said the name into the Sudio Vogue, the Sudio Vogue will repeat the name and then begin automatically dialling the number. To end the call, push the multi-function button with one quick press.

* the voice dialling function is handset dependant. Consult your mobile phone's user guide to see if it supports voice dialling.

3.2.4 Transferring calls between the Sudio Vogue and your mobile phone

To transfer a call from the Sudio Vogue to your mobile phone, hold down the volume up and down arrow keys simultaneously. Press the multi-function button to transfer a call from your mobile phone back to the Sudio Vogue.

3.2.5 Last number redial

To redial the last number you called, press the multi-function button of the Sudio Vogue twice. You will hear a low tone indicating that it has initiated a redial.

3.2.6 Volume Up / Down

Use the up and down arrow keys located in the middle of the Sudio Vogue to adjust the volume. You'll hear a beep indicating a change in tone so you can set it at the desired level.

3.2.7 Mute / Un-mute

Press the mute button on the top of the Sudio Vogue for 3 seconds to mute the sound during a call. The red indicator LED will light up indicating that it is on mute. You will be able to hear the other person but they won't be able to hear you. To un-mute the call, repeat this again holding it down for 3 seconds. The blue indicator LED will light up indicating that your caller can hear you again.

3.2.8 Auto Power Off

The Sudio Vogue will automatically turn itself off after one hour to preserve battery life. This function will only work if your mobile phone is disconnected from the Sudio Vogue, otherwise it will remain powered on.

To turn the Sudio Vogue back on hold the multi-function button for 3 seconds until you hear a short beep.

3.2.9 Reject a call

Reject an incoming call by holding down the multi-function button for 3 seconds until you hear a short beep.





4.0 Maintenance

The Sudio Vogue is a well-designed Bluetooth communications device. Careful maintenance and proper use will extend the product life of your Sudio Vogue and ensure optimum performance. The following procedures will assist you with the maintenance of your Sudio Vogue.

- Keep the device dry, away from water, precipitation, humidity, moisture, and various liquids that may corrode electronic circuits.
- Keep the device away from dust and dirt to protect the mechanic and electronic parts.
- Do not store the Sudio Vogue in high temperatures above 60°C or in direct sunlight as extreme high temperature could degrade performance and warp or melt certain plastics.
- Do not store the device in cold places (under -20°C) as moisture could form inside the device when you take it to a warm place. This could damage the internal electronic circuits.
- Do not charge the Sudio Vogue if temperatures are above 60°C or below 20°C
- Avoid dropping and knocking the device. The mechanical parts and the internal electronic circuits could break.
- Avoid using harsh chemicals, cleaning solvents, and any other strong detergent to clean the device.
- Always take the Sudio Vogue to the point of purchase if it is malfunctioning.
- Disassembling, modifying and replacing components yourself could degrade the product's performance and void its warranty.
- Keep your receipt and warranty card in a safe place for proof of purchase to benefit from your 2 year warranty.



5.0 Frequently Asked Questions

Do I need to turn the Sudio Vogue on and off every time I get in and out of my car?

This will depend on how long you have been away from your car. The Sudio Vogue has an Auto-Power off function which means it will turn itself off automatically after an hour to preserve its battery life (provided your mobile phone is disconnected from it).

How long do I stay connected for?

Provided the Sudio Vogue and your mobile phone are within the operating range of 10 metres, they will stay connected to each other.

Will my mobile phone automatically connect when I'm in range of the Sudio Vogue?

Most mobile phones will auto connect to a paired device when you're within range (provided they have been previously paired). If your mobile phone doesn't auto connect, navigate to your Bluetooth devices list in your mobile phone.

How can I tell if I'm connected?

If your mobile phone is connected to the Sudio Vogue, you will see the connection status on your mobile phone.

Do I have to pair the Sudio Vogue and my mobile phone every time I want to use it?

No you don't. Once you've paired your Sudio Vogue and your mobile phone, they will always be paired and should appear in your paired devices list on your mobile phone. However, when you want to use these two devices together you'll need to make sure they are 'connected' with each other. Refer to section 3.1.1 for instructions on connecting.

The Sudio Vogue cannot be found when my mobile phone tries to pair with it?
The Sudio Vogue may not be in pairing mode. Refer to section 2.3.3 for instructions on pairing.



6.0 Technical Specifications

Size and Weight:

Length: 123 mm

Depth: 46 mm

Width: 20 mm

Weight: 100g

Package Dimensions : 211 x 165 x 41mm

Performance:

Talk time: up to 10 hours

Stand-by time: up to 480 hours

Charging Time: 2-3 hours

Battery: Replaceable 650mAH rechargeable lithium polymer battery

Bluetooth Spec:

Type: Version 2.0

Transmit power : Class 2

Data range: Distance up to 5 meters.

Backwards compatible with Bluetooth versions 1.1 and 1.2

TECH SPECS



**Supported profiles:**

Hands-Free Profile (HFP)

Headset Profile (HSP)

Other:

Regulatory Compliance : CE, FCC, SIG

Operation Mode : Full Duplex with Noise and Echo Cancellation Using DSP

Operating Temperature : between -10°C and 70°C

Storage Temperature : between -20°C and 60°C

Speaker : 2W

CE FC  N363620 |  SUDIO

NOTES





NOTES



